

## AZAI8HB2T02 - Aidoo Pro HUB Toshiba Domestic

Location:	Approval:
Engineer:	Date:
Submitted to:	Construction:
Submitted by:	Unit #:
Reference:	Drawing #:
Additional Info:	

### MODEL DESCRIPTION

Device to manage and integrate units remotely from the Cloud. Online control with the "Airzone Cloud" App (available for iOS and Android). Wired network connection via Ethernet or wireless via Dual Wi-Fi (2.4/5 GHz). Features:

- Unit control and error detection.
- Configurable digital input for open window detection or occupancy presence.
- Auxiliary heat control and heat source locking.
- Automatic change of the operation mode with the adjustment of two set-point temperatures.
- Temperature limitation for cooling and heating modes.
- Status, temperature, mode and speed time schedules.
- Integration: Modbus RTU/TCP or BACnet MS-TP/IP, Airzone thermostat, Lutron Palladiom thermostat. Cloud integration with third-party smart thermostats (3PI).
- Local API and Cloud API integration services, mDNS multicast.

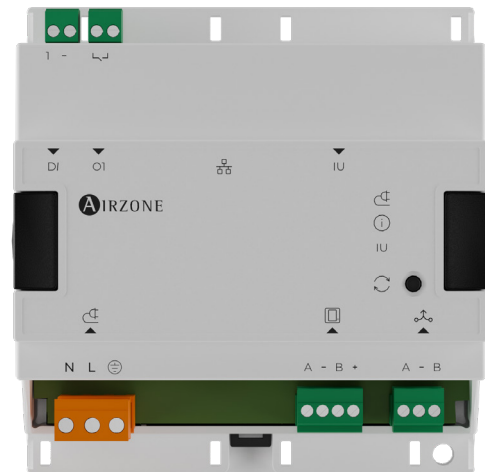

[Click to download](#)

### TECHNICAL SPECS

<b>⚡ - Power supply</b>	
V max	110 / 230 Vac
I max	250 mA
Frequency	60 / 50 Hz
Stand-by consumption	110 Vac (3.4 W) 230 Vac (4.3 W)
Module over-current protection	250 mA
<b>📶 - Airzone bus</b> <b>🔌 - Integrations bus</b>	
Shielded twisted pair	AWG 24 – 2 wired + AWG 20 – 2 wired (2 x 0.20 + 2 x 0.5 mm <sup>2</sup> ) AWG 24 – 2 wired + AWG 20 – 1 wired (2 x 0.20 + 1 x 0.5 mm <sup>2</sup> ) Min: AWG 24 (0.2 mm <sup>2</sup> ) / Max: AWG 15 (1.5 mm <sup>2</sup> )
Communications protocol	RS-485 BACnet MS-TP Par – 19200 bps
<b>DI - Digital input</b>	
Voltage-free	
Max. distance	32.8 ft (10 m)
<b>O1 - Relay output</b>	
Voltage-free	
V max (I max)	230 Vac (5A) 30 Vdc (3A)
<b>🌐 - Ethernet</b>	
Type of cable	Min. UTP cat 5
Standard	100BASE-TX
IP address	DHCP

<b>IU - Connection to indoor unit</b>	
Max. distance.	32.8 ft ( 10 m)
<b>Wi-Fi</b>	
Protocol	WI-FI – CERTIFIED TM 802.11a/b/g/n/ac (802.11n up to 150 Mbps)
Model	LBEE5HY1MW
Communication frequency	2.4 GHz (max. 150 Mbps) 5 GHz (max. 433 Mbps)
Max. power, Antenna power	17.93 dBm, 0.1 dBi
Sensitivity	- 82 dBm
IP address	DHCP
<b>Bluetooth</b>	
Protocol	Bluetooth v5.0 EDR and BLE specification
Bluetooth class	Class-1, class-2 and class-3 transmitter
Max. power, Antenna power	5.46 dBm, 0.1 dBi
<b>Operating temp.</b>	
Storage	- 4 ... 158 °F (- 20 ... 70 °C)
Operation	32 ... 113 °F (0 ... 45 °C)
Operating humidity range	5 ... 90 % (non-condensing)
<b>Mechanical aspects</b>	
WProtection class	IP 20
Weight	0.46 lb (210 g)
In DIN units	6
Max. operating height	6561.68 ft (2000 m)

## DIMENSIONAL DRAWINGS

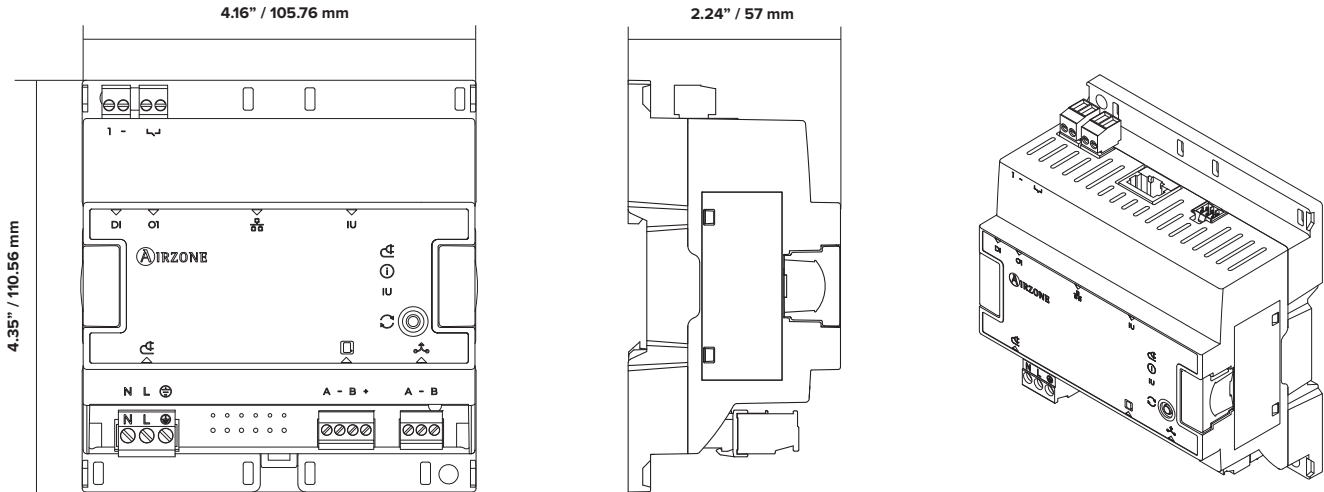

## INSTALLATION

Installation requirements:

- This equipment is not suitable for use in locations where children are likely to be present.
- It is necessary to mount this device into a CSA Certified / UL Listed electric enclosure.
- In case of performing the LEAP integration through a Wi-Fi connection, it is recommended that the CSA Certified / UL Listed electric enclosure used be made of ABS, polycarbonate, or glass-fiber-reinforced polyester.
- Protective earthing of the equipment shall be connected to the protective earthing conductor of the building installation.
- An external all-pole mains switch in accordance with Annex L of IEC 62368-1 shall be provided as part of the final installation.

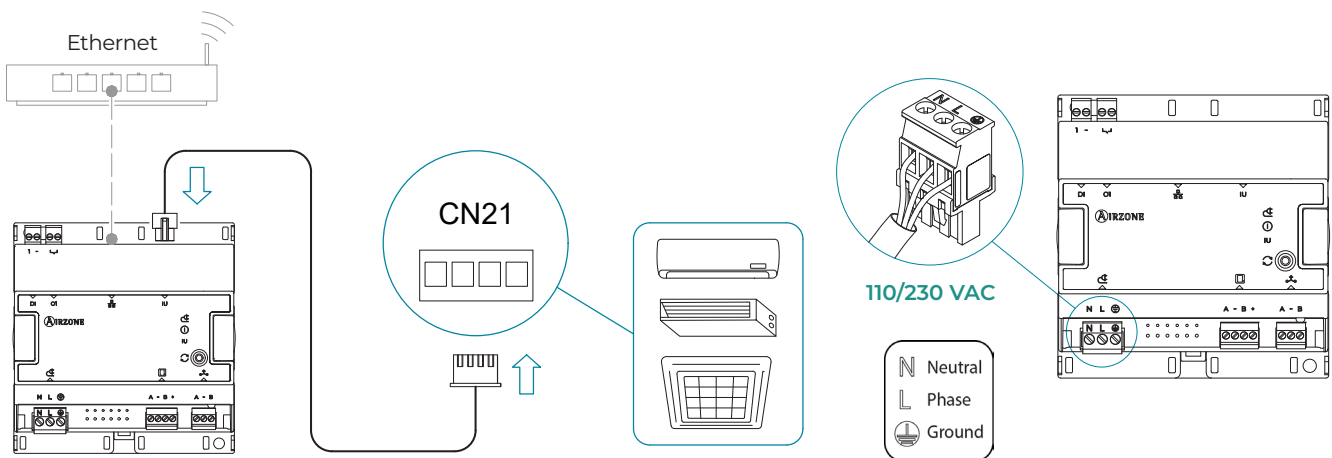

## SPARE PARTS

- AZPV8WIRE28 - Connection to Indoor unit 8.2 ft (2.5 m) / AWG 24 - 6 wired (6x0.2 mm<sup>2</sup>)

## ACCESORIES

- AZAI6BLUEZERO[C/N] - Airzone Aidoo Pro Blueface Zero Color Thermostat Wired
- AZPV8WIREU - Universal 6-pin 8.2 ft (2.5 m) extension cable for Airzone gateway / Aidoo



[airzonecontrol.com](http://airzonecontrol.com)

Marie Curie, 21  
29590 Málaga, Spain

